

The background features a watercolor-style world map in shades of teal and green. Overlaid on the map are several abstract geometric patterns, including concentric circles, arcs, and dotted lines in various colors like teal, green, and grey. The overall aesthetic is modern and artistic.

Ripley's *Believe It or Not!*

**WILLARD WIGAN**  
**MICROSCULPTOR**



*RIPLEY'S*  
**Believe It or Not!**<sup>®</sup>

**DESIGN AND DEVELOPMENT PACKAGE**

DESIGN DEVELOPMENT DRAWINGS  
\*\*\*NOT FOR CONSTRUCTION\*\*\*  
FIELD VERIFY ALL MEASUREMENTS

**WILLARD WIGAN**  
MICROSCULPTOR

**WILLARD WIGAN TRAVELING SHOW**  
DESIGN & DEVELOPMENT PACKAGE - 9-2019

**RIPLEY**

ENTERTAINMENT, INC.  
7576 KINGSPONTE PKWY #188  
ORLANDO, FLORIDA 32819  
(407) 345-8010

WWW.RIPLEYS.COM

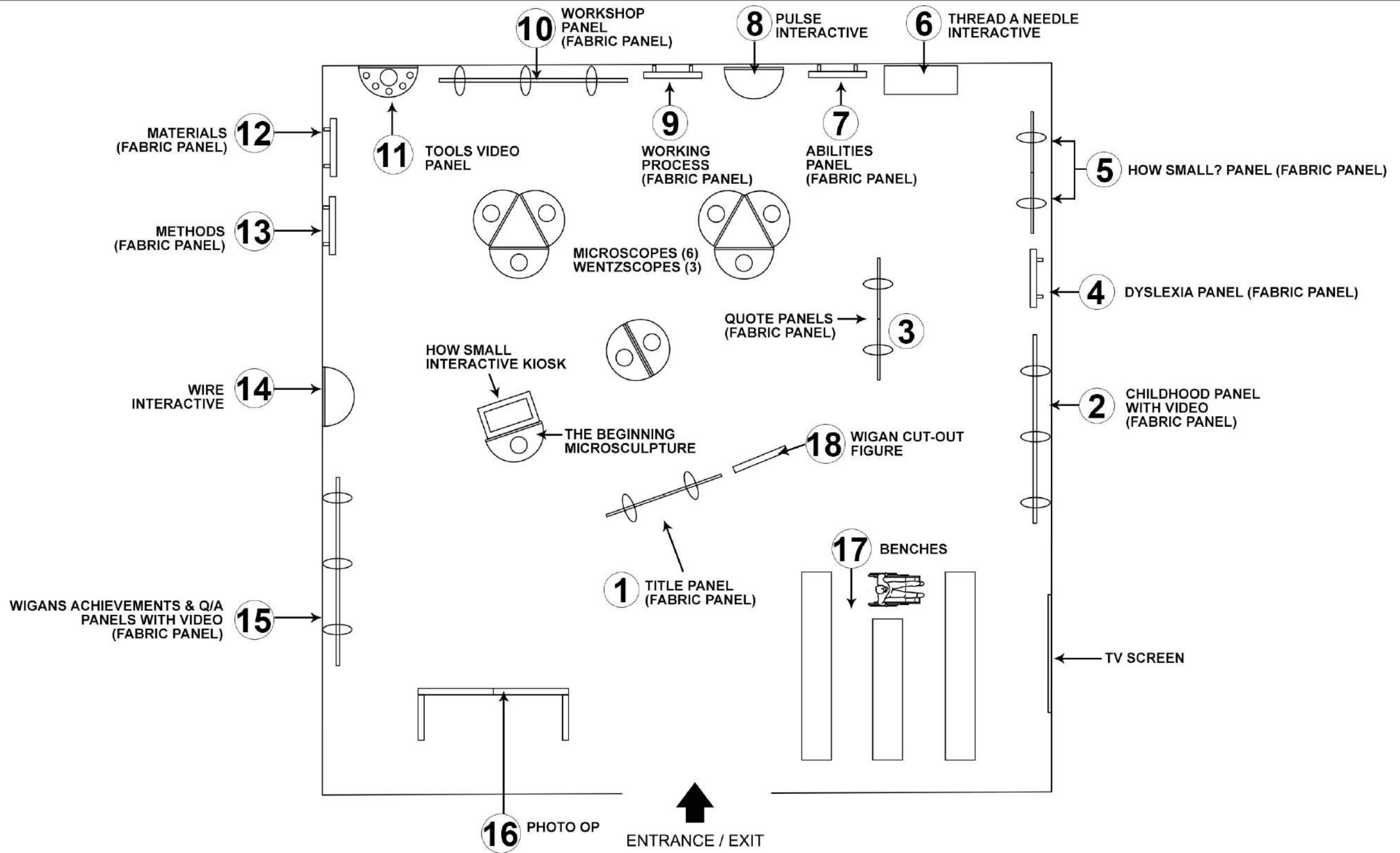

**RIPLEY**  
 ENTERTAINMENT, INC.  
 7576 KINGSPONTE PKWY #188  
 ORLANDO, FLORIDA 32819  
 (407).345.8010  
 WWW.RIPLEYS.COM

PROJECT LOCATION:  
 NOTES:

PROJECT TITLE:  
**Ripley's Believe It or Not!**

DATE: 10-1-18  
 REVISED DATE: 9-6-19  
 SCALE: 3/16" = 1'

DRAWN BY:  
 C. COYLE  
 APPROVED BY:

SHEET #  
 WIGAN SHOW LAYOUT

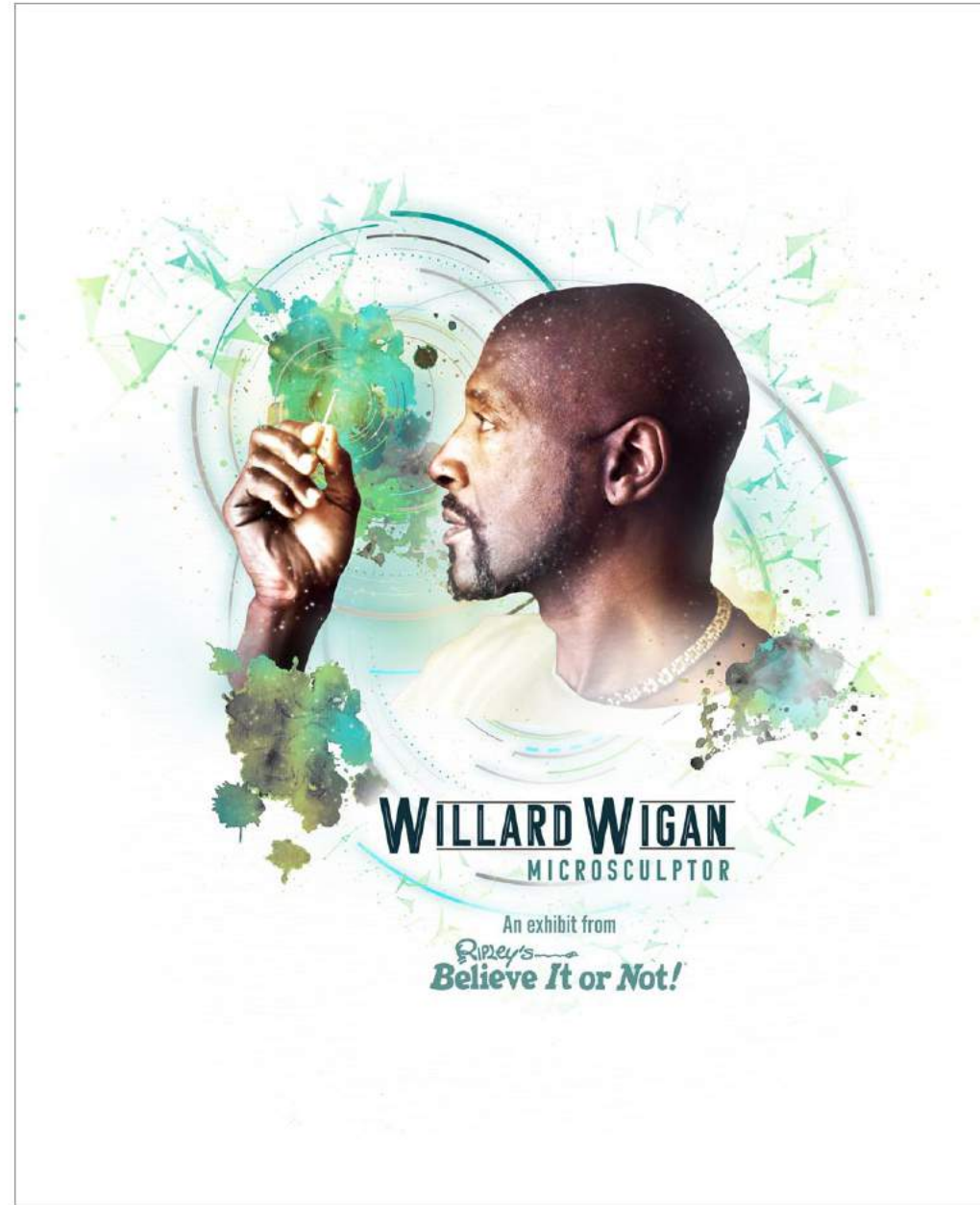

1 TITLE GRAPHIC (1 PANEL)

KEY ELEVATION

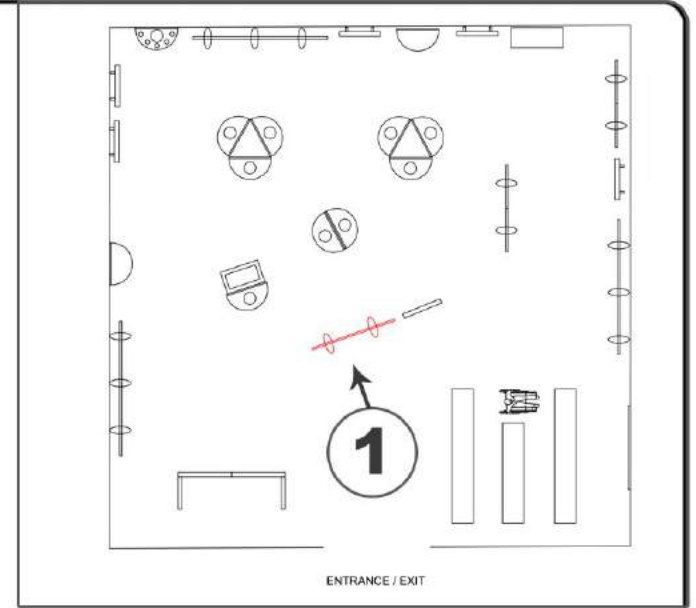

**RIPLEY**  
ENTERTAINMENT, INC.  
7576 KINGSPONTE PKWY #188  
ORLANDO, FLORIDA 32819  
(407).345.8010  
  
WWW.RIPLEYS.COM

PROJECT LOCATION:  
  
NOTES:

PROJECT TITLE:  
**Ripley's**  
**Believe It or Not!**

DATE:  
10-1-18  
REVISED DATE:  
9-6-19  
SCALE:

DRAWN BY:  
C. COYLE  
APPROVED BY:

SHEET #



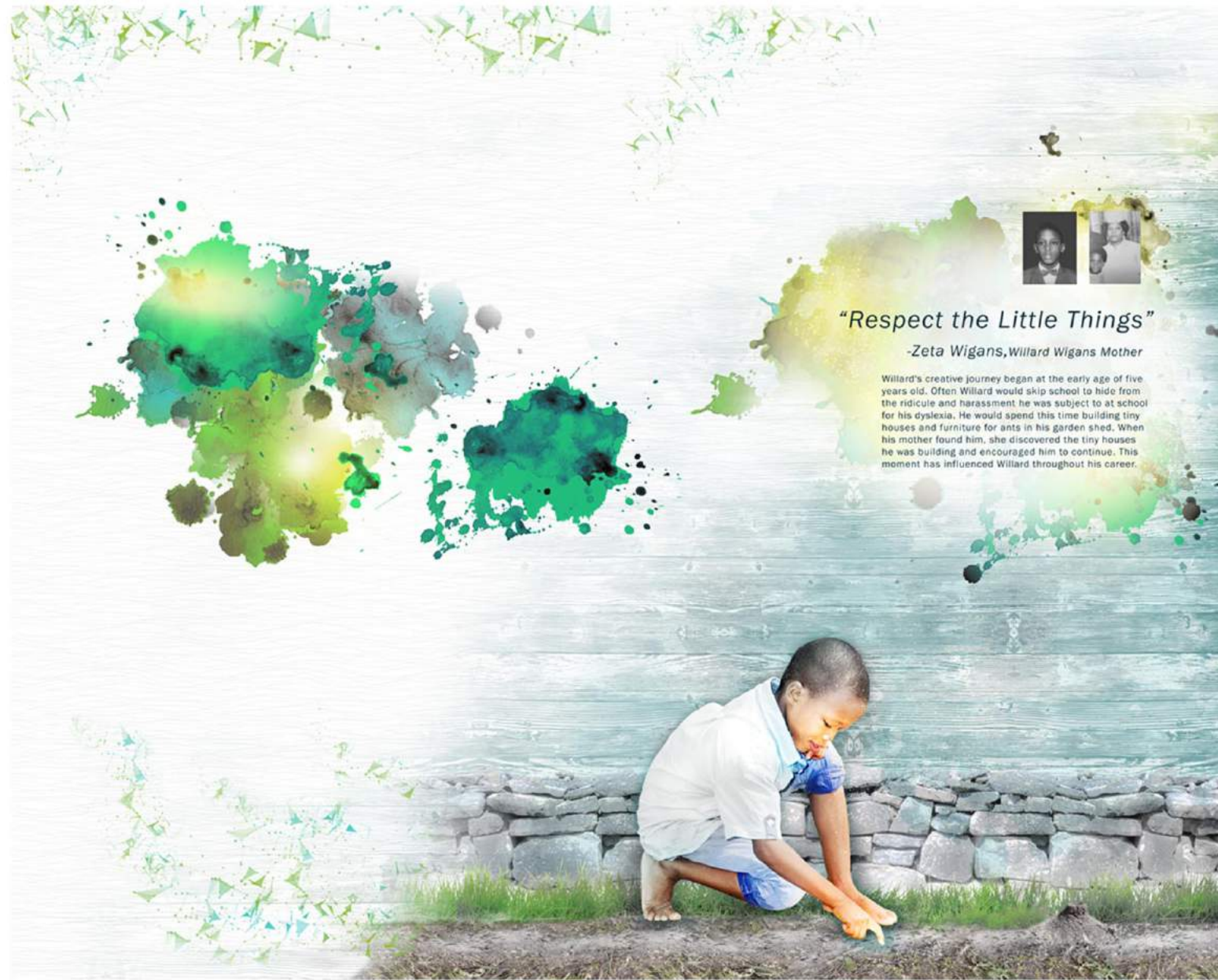

**2** CHILDHOOD STORY

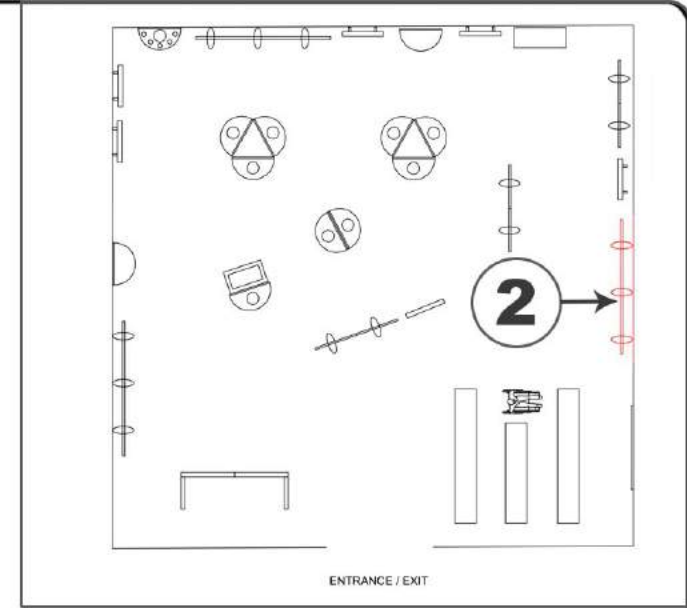

**KEY ELEVATION**

**RIPLEY**  
 ENTERTAINMENT, INC.  
 7576 KINGSPONTE PKWY #188  
 ORLANDO, FLORIDA 32819  
 (407).345.8010  
 WWW.RIPLEYS.COM

PROJECT LOCATION:  
 NOTES:

PROJECT TITLE:  
**Ripley's**  
**Believe It or Not!**

DATE:  
 10-1-18  
 REVISED DATE:  
 9-6-19  
 SCALE:

DRAWN BY:  
 C. COYLE  
 APPROVED BY:

SHEET #



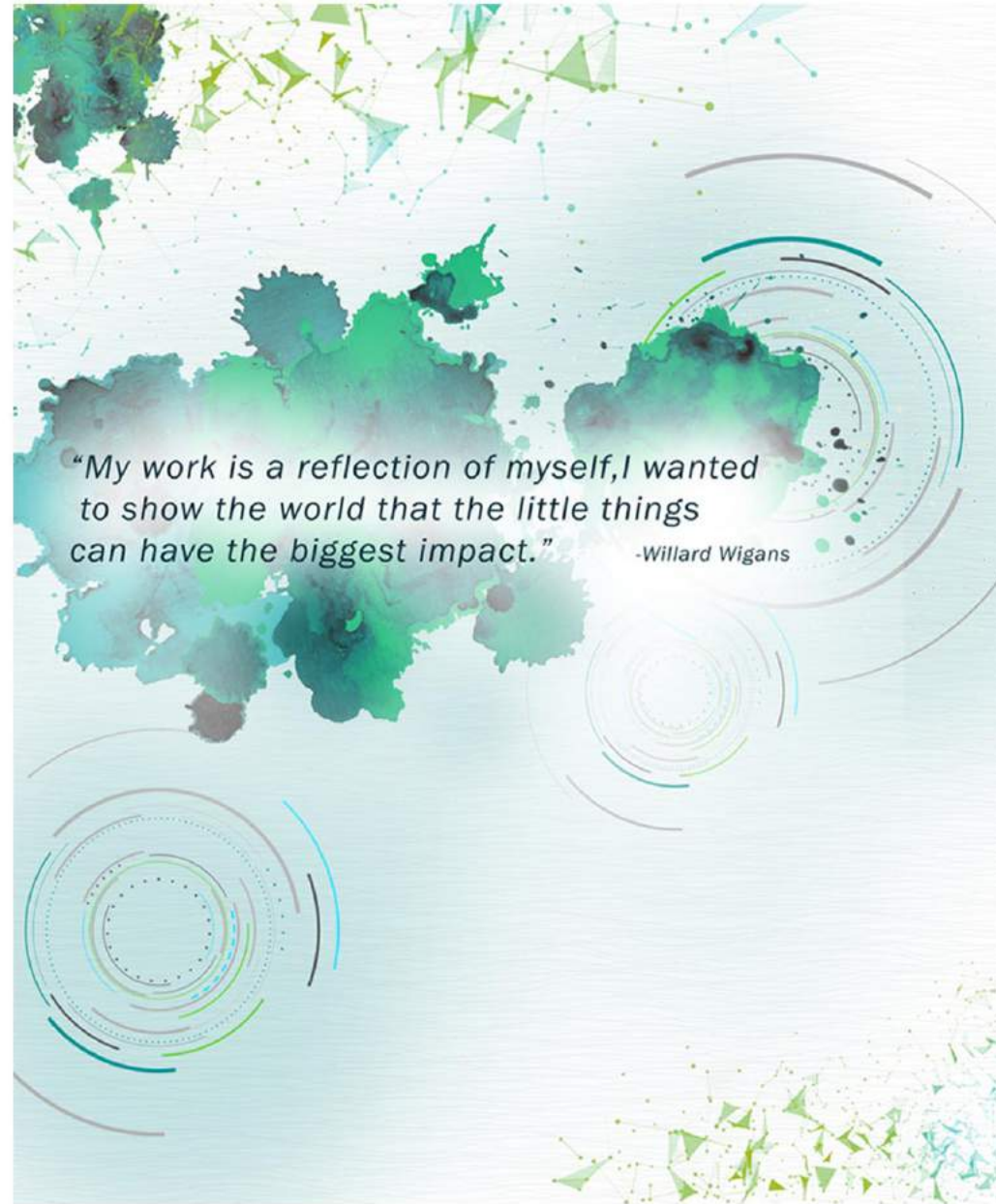

**3** WIGAN QUOTES (1 PANELS DOUBLE-SIDED)

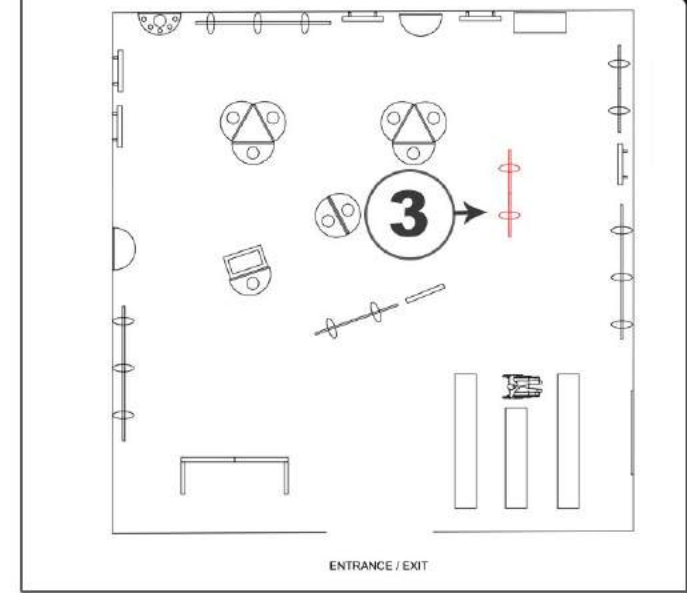

**KEY ELEVATION**

**RIPLEY**  
ENTERTAINMENT, INC.  
7576 KINGSPONTE PKWY #188  
ORLANDO, FLORIDA 32819  
(407).345.8010  
  
WWW.RIPLEYS.COM

PROJECT LOCATION:  
  
NOTES:

PROJECT TITLE:  
**Ripley's**  
**Believe It or Not!**

DATE:  
10-1-18  
REVISED DATE:  
9-6-19  
SCALE:

DRAWN BY:  
C. COYLE  
APPROVED BY:

SHEET #





## DYSLEXIA

How did Dyslexia change Willard's life?

*"I want to inspire people especially those people who have a learning difference like me. If I never had this condition, I wouldn't be who I am today. I want to show them what can be achieved if you try."* -Willard Wigan

**Willard's Experience**  
 Unlike today, no one talked about dyslexia in the 1960s, and so young Willard's learning problems went unexplained. His teachers told him that he was stupid and would never amount to anything. They paraded him in front of the classroom, and when he could not do the work, one of his teachers pointed to him and explained to the class that, "Willard is an example of failure."  
 Unfortunately, Willard was victimized over his learning disability as a child. However, he has been able to overcome his disadvantages and achieve a successful career as an artist.

**What is Dyslexia?**  
 A disorder that involves difficulty in learning to read or interpret words, letters, and other symbols, but that does not affect general intelligence.

**Famous Dyslexics**

- Pablo Picasso - Painter**  
Pablo Picasso paintings demonstrated the power of "dyslexic" imagination as well as raw or primary emotion and creativity within the human psyche.
- Steven Spielberg - Director**  
One of the most popular and influential directors of all time, Steven Spielberg was diagnosed with dyslexia in 2007.
- Tom Cruise - Actor**  
Tom Cruise grew up and succeeded despite poverty, frequent relocations, inadequate schooling and dyslexia.

Dyslexia affects over 40 million American children and adults.

**4** DYSLEXIA (1 PANEL)

## HOW SMALL?

How small are Willard's sculptures?

*"At school, I couldn't express myself and felt like 'nothing.' I wanted to experiment with the world that we can't see."* -Willard Wigan

**That's an eyelash!**  
1/16" of an inch

**6"**  
The actual size of a pen is 6 inches. The picture shows the tip of the pen next to one of the sculptures.

**That's a panther in the blade of a razor!**  
1/8" of an inch

**5** HOW SMALL (2 PANELS WITH TV)

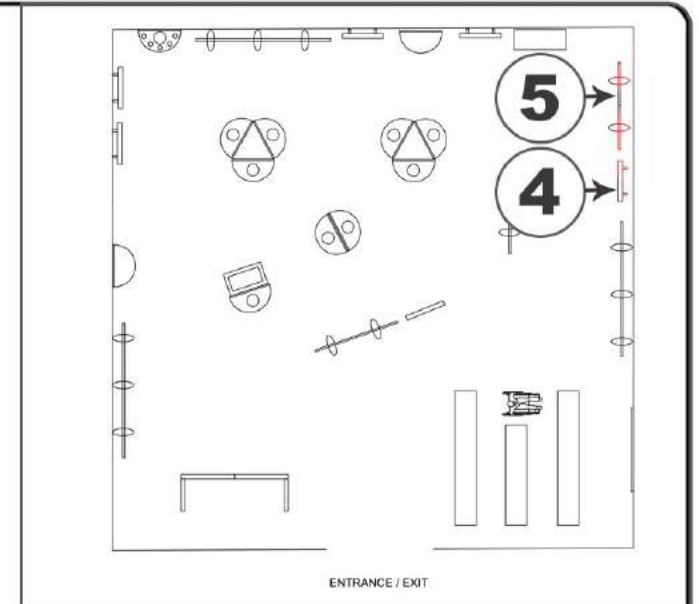

**KEY ELEVATION**

**RIPLEY**  
 ENTERTAINMENT, INC.  
 7576 KINGSPONTE PKWY #188  
 ORLANDO, FLORIDA 32819  
 (407).345.8010

WWW.RIPLEYS.COM

PROJECT LOCATION:

NOTES:

PROJECT TITLE:

**Ripley's**  
**Believe It or Not!**

DATE:  
10-1-18

REVISED DATE:  
9-6-19

SCALE:

DRAWN BY:  
C. COYLE

APPROVED BY:

SHEET #



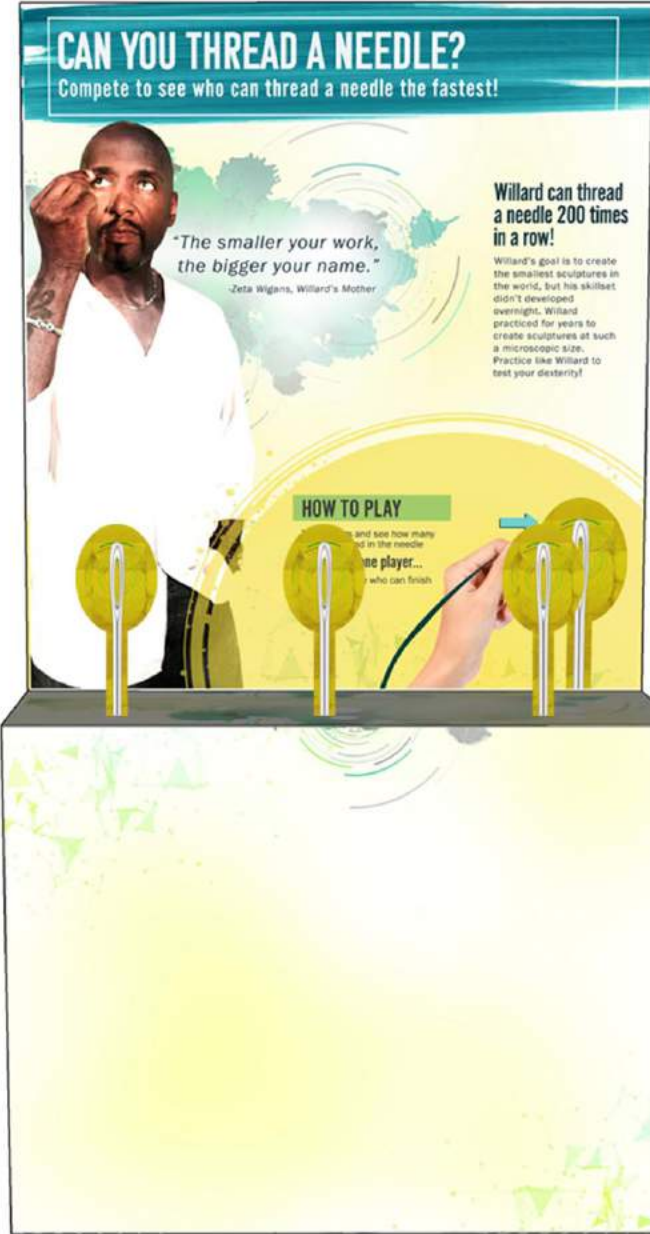

**6** CAN YOU THREAD A NEEDLE



**7** WIGAN'S ABILITIES

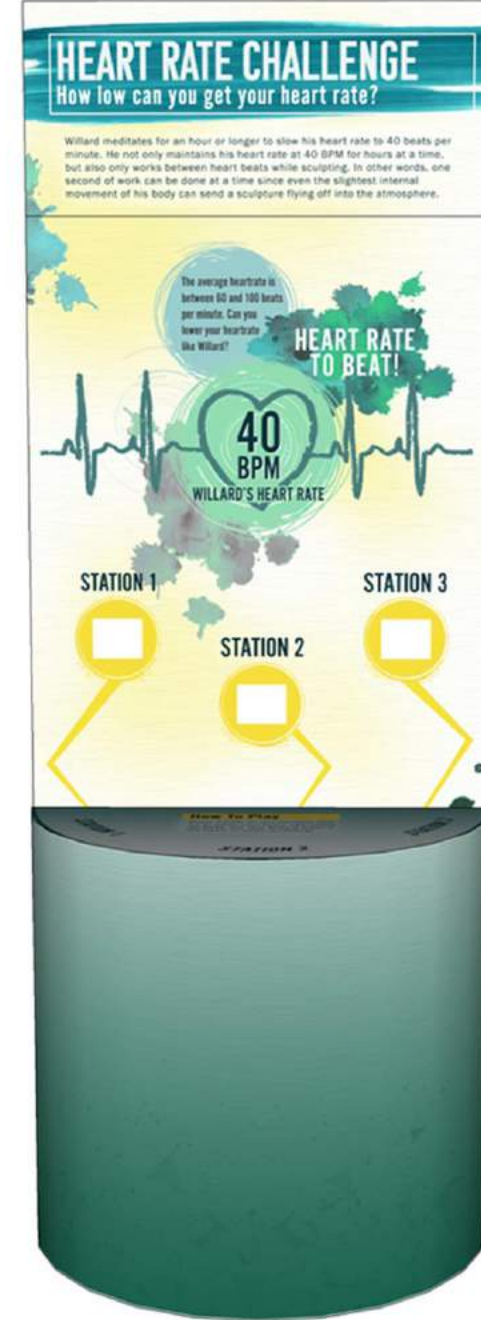

**8** PULSE INTERACTIVE

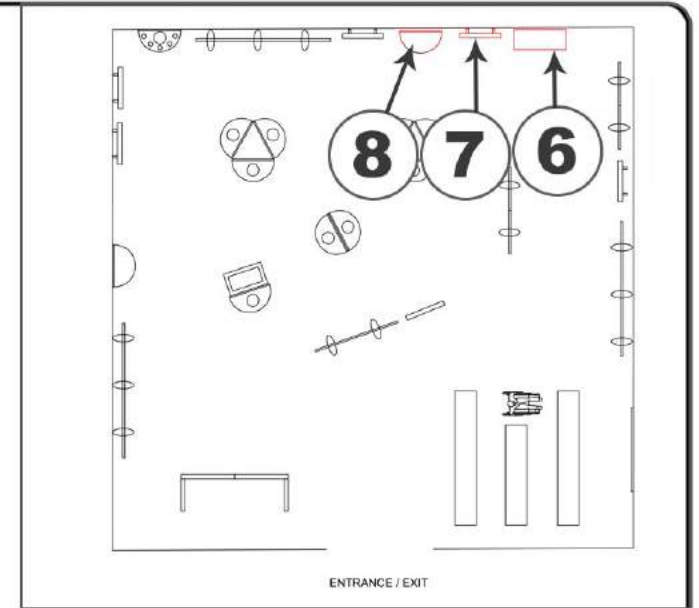

**KEY ELEVATION**

**RIPLEY**

ENTERTAINMENT, INC.  
7576 KINGSPONTE PKWY #188  
ORLANDO, FLORIDA 32819  
(407).345.8010

WWW.RIPLEYS.COM

PROJECT LOCATION:

NOTES:

PROJECT TITLE:

*Ripley's*  
**Believe It or Not!**

DATE:  
10-1-18

REVISED DATE:  
9-6-19

SCALE:

DRAWN BY:

C. COYLE

APPROVED BY:

SHEET #





## WORKING PROCESS

What is Willard's work routine?

*"When I'm not working I just keep quiet. I've trained my attention span, trained my patience, I will stay still for six hours – just deliberately sit there, doing nothing, no moving."* -Willard Wigan

Willard can work for 16 hours at a time. However, to achieve the mental and physical state of concentration to do this, he must meditate and be in the right atmosphere.



**Process**

- Meditation**  
Willard takes as much time as needed to prepare himself for the strenuous concentration needed for working on his minatures.
- Be completely quiet and still**  
Willard must be extremely still and quiet while working with such minute materials.
- Slow Heartbeat**  
Willard is capable of slowing his heart rate to 40bpm. This allows him time to work in between heartbeats and reduces hand tremors.
- Concentration**  
Willard says working at that scale is a stressful process. To maintain the level of focus necessary and not get frustrated is not an easy skill to obtain. He's been training his body and mind for decades.

**Conditions**

- Night**  
Working through the night has the least noise distractions.
- Dietary**  
"I don't drink coffee or tea. No caffeine, no alcohol. I do practice, drink lot of water, eat lots of salad, fill my body with lots of vegetables and fruit." -Willard
- Social**  
"No arguments. I don't want to argue with anybody. You can debate, but no arguments. Equilibrium." -Willard

**Musical Influence**  
Sometimes Willard will listen to music while working. Some of the artists he enjoys are The Carpenters, Burt Bacharach, Stevie Wonder, Donny Hathaway, Marvin Gaye, The Beatles, Blood, Sweat and Tears, Hendrix, Santana.

**9** CAN YOU THREAD A NEEDLE

## "The microscopic world became my obsession" -Willard Wigan

Willard creates his microsculptures from a small bedroom in his apartment in Birmingham, England. He works in the dead of the night, when it is the most quiet and for several hours at a time. Besides the physical challenges and skill level of working at such a small scale, other elements can effect his work. Such as static electricity from him piecing together a sculpture or even a piece of dust falling into his work space can destroy hours or weeks of work.

**Before he was a successful artist...**  
For two decades, Willard worked during the day in a factory and sculpted his minatures at night. He also had a job as a live mannequin for a clothing store. Here he could practice staying still and holding his breath for long periods of time.



The slightest movement could ruin a sculpture. Willard must work in a small, quiet space without interruptions.



Willard has his tools specially designed for sculpting minatures.



Willard's sculptures are so tiny, it can be almost impossible to see unless you use a microscope.



Willard's desk is surrounded with necessary materials and supplies.

Willard in his home studio space in Birmingham, England.

**10** WIGAN WORKSHOP

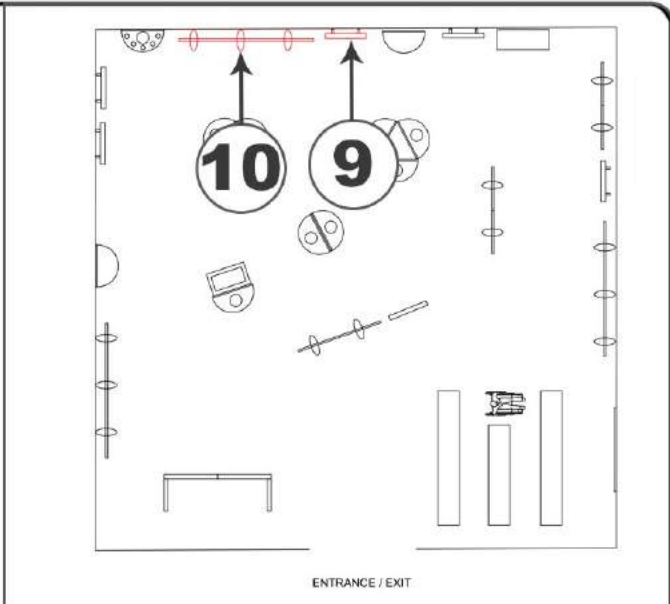

**KEY ELEVATION**

**RIPLEY**  
ENTERTAINMENT, INC.  
7576 KINGSPONTE PKWY #188  
ORLANDO, FLORIDA 32819  
(407).345.8010  
  
WWW.RIPLEYS.COM

PROJECT LOCATION:  
  
NOTES:

PROJECT TITLE:  
**Ripley's Believe It or Not!**

DATE: 10-1-18  
REVISED DATE: 9-6-19  
SCALE:

DRAWN BY:  
C. COYLE  
APPROVED BY:

SHEET #



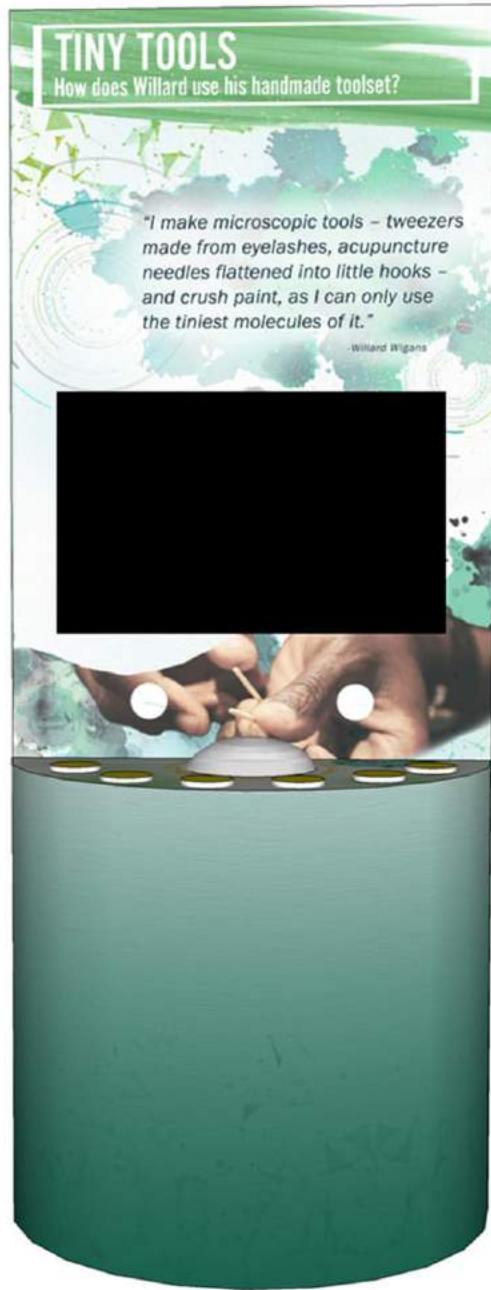

**11** TOOL VIDEO PANEL



**12** MATERIALS



**13** METHODS

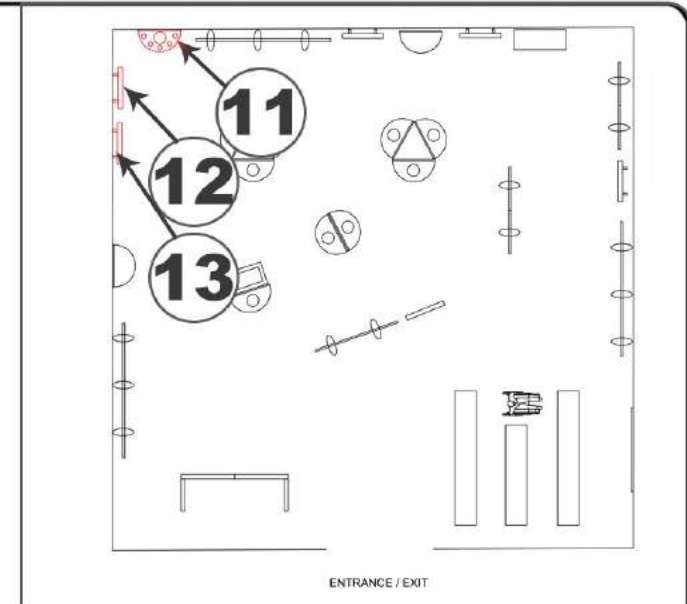

**KEY ELEVATION**

**RIPLEY**  
ENTERTAINMENT, INC.  
7576 KINGSPONTE PKWY #188  
ORLANDO, FLORIDA 32819  
(407).345.8010  
  
WWW.RIPLEYS.COM

PROJECT LOCATION:  
  
NOTES:

PROJECT TITLE:  
**Ripley's Believe It or Not!**

DATE:  
10-1-18  
REVISED DATE:  
9-6-19  
SCALE:

DRAWN BY:  
C. COYLE  
APPROVED BY:

SHEET #



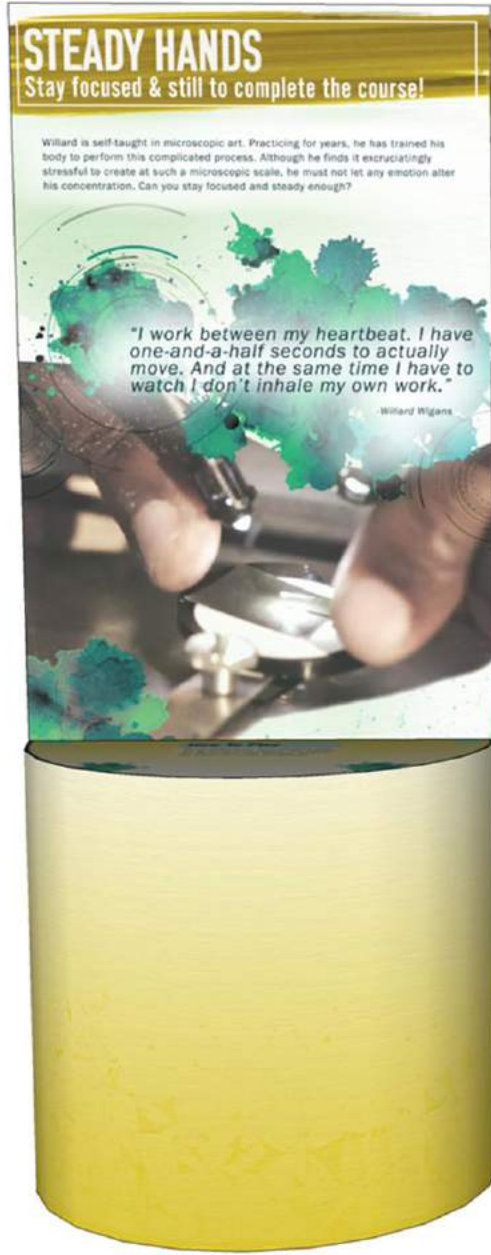

**14** WIRE INTERACTIVE

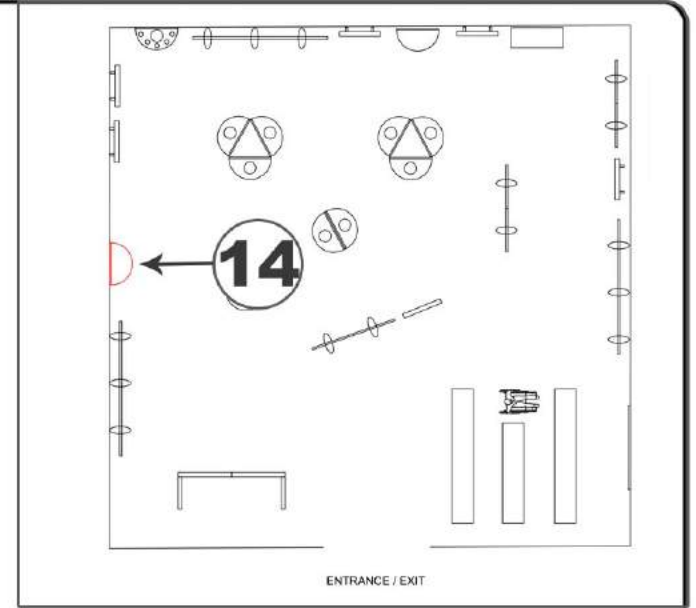

**KEY ELEVATION**

**RIPLEY**  
 ENTERTAINMENT, INC.  
 7576 KINGSPONTE PKWY #188  
 ORLANDO, FLORIDA 32819  
 (407).345.8010  
 WWW.RIPLEYS.COM

PROJECT LOCATION:  
 NOTES:

PROJECT TITLE:  
**Ripley's**  
**Believe It or Not!**

DATE:  
 10-1-18  
 REVISED DATE:  
 9-6-19  
 SCALE:

DRAWN BY:  
 C. COYLE  
 APPROVED BY:

SHEET #





*"I was told I would become nothing. Now I am showing people how big nothing is." -Willard Wigans*

**Q/A with Willard**

**1** What's your favorite sculpture?  
*The Last Supper*

**2** Why?  
*Because of the movement and amount of figures in the sculpture. It was very challenging*

**3** What is the strangest thing to happen to you?  
*I once swallowed one of my pieces, Alice and Wonderland. I'd got the Mad Hatter, the teapot, the Hare, the Dormouse, and the Rabbit, so Alice was last. And I got the shape of her, and painted her with an eyelash, and then I went to put her behind a chair, and my mobile phone went off. And you know when your mobile phone goes off when you don't want it to, the first thing you do is inhale. And there was no more Alice.*

**4** So do you feel like you're getting better at your work?  
*Oh yeah, I'm getting better. The world hasn't seen Willard Wigan yet. They're going to see a lot more. My mum used to say "Be the Muhammed Ali of microscopic work." I used to see him on TV going "I am the greatest," and I thought "Yeah, I'm going to become that." He's someone who has really inspired me. I love artists like Michelangelo, Salvador Dali, Henry Moore. I look up to greatness. It doesn't matter if it's art or tennis or football, I like seeing greatness. And I hope that I'm an inspiration to other kids who have autism. Not just people with autism, anyone with low self-esteem. I'm here to deliver the smallest, biggest message in the world.*

**Willard's Achievements**

**1995** Film Credit: *An Eye on X*  
A short film about Wigan carving two pieces of American brass which Malcolm X is commemorates his visit to Smallwood, Birmingham in 1963.

**2000** National Award: Most Excellent Order of the British Empire  
Willard was awarded a MBE by Prince Edward for his contributions to the arts.

**2007** U.S. Art Exhibitions  
Between 2009 and 2010, Willard has several exhibitions in the U.S.

**2009** TED Global Conference  
"Hold your breath for Micro-Sculptures"  
Willard was invited to speak at TED Global in Oxford, UK in July of 2009.

**2009** Television Appearance  
Tonight Show  
Willard makes a guest appearance on the Tonight Show with Conan O'Brien.

**2010** Royal Commission  
Willard accepts the Queen's portrait on a coffee bean for the Diamond Jubilee of Elizabeth.

**2012** Doctorate Degree  
Willard received an honorary doctorate from the University of Warwick in recognition of the significant contributions that he has made to art and sculpture.

**2013** Guinness World Record: Smallest Sculpture made by hand  
The sculpture "Queen Victoria" becomes a Guinness World Record. It measures at 3 microns, which is smaller than a human blood cell.

**2018** Guinness World Record: Smallest Sculpture made by hand  
Willard received his second world record for his work titled "The Beginning".

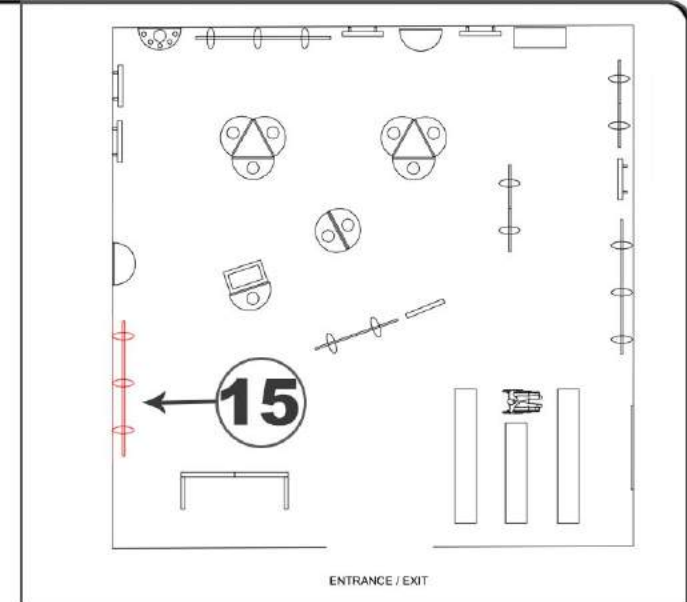

**KEY ELEVATION**

**15** WIGAN'S ACHIEVEMENTS (3 PANELS)

**RIPLEY**  
ENTERTAINMENT, INC.  
7576 KINGSPONTE PKWY #188  
ORLANDO, FLORIDA 32819  
(407).345.8010  
  
WWW.RIPLEYS.COM

PROJECT LOCATION:  
  
NOTES:

PROJECT TITLE:  
**Ripley's Believe It or Not!**

DATE:  
10-1-18  
REVISED DATE:  
9-6-19  
SCALE:

DRAWN BY:  
C. COYLE  
APPROVED BY:

SHEET #





Front Concept Render



2

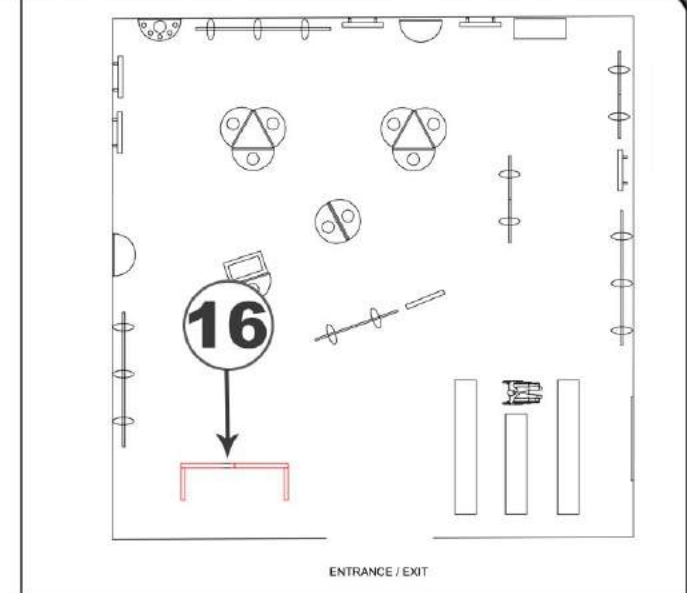

KEY ELEVATION

Back Concept Render

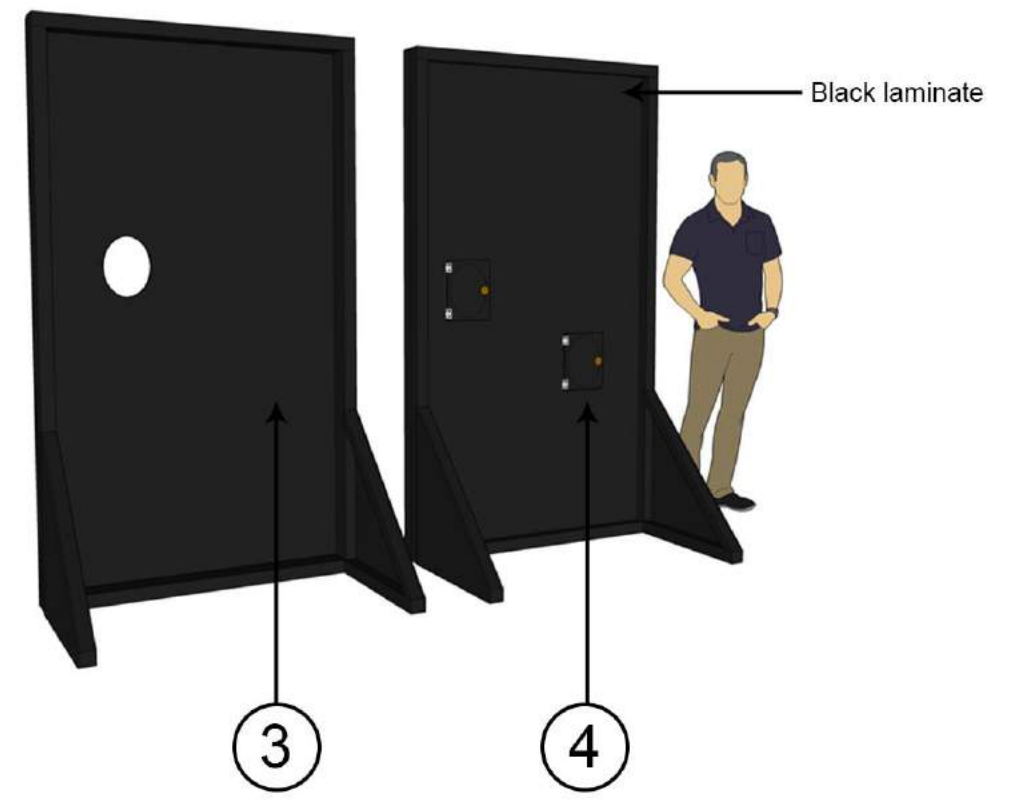

16 WIGAN'S PHOTO OP

**RIPLEY**  
ENTERTAINMENT, INC.  
7576 KINGSPONTE PKWY #188  
ORLANDO, FLORIDA 32819  
(407).345.8010  
  
WWW.RIPLEYS.COM

PROJECT LOCATION:  
  
NOTES:

PROJECT TITLE:  
**Ripley's**  
**Believe It or Not!**

DATE:  
10-1-18  
REVISED DATE:  
9-6-19  
SCALE:

DRAWN BY:  
C. COYLE  
APPROVED BY:

SHEET #



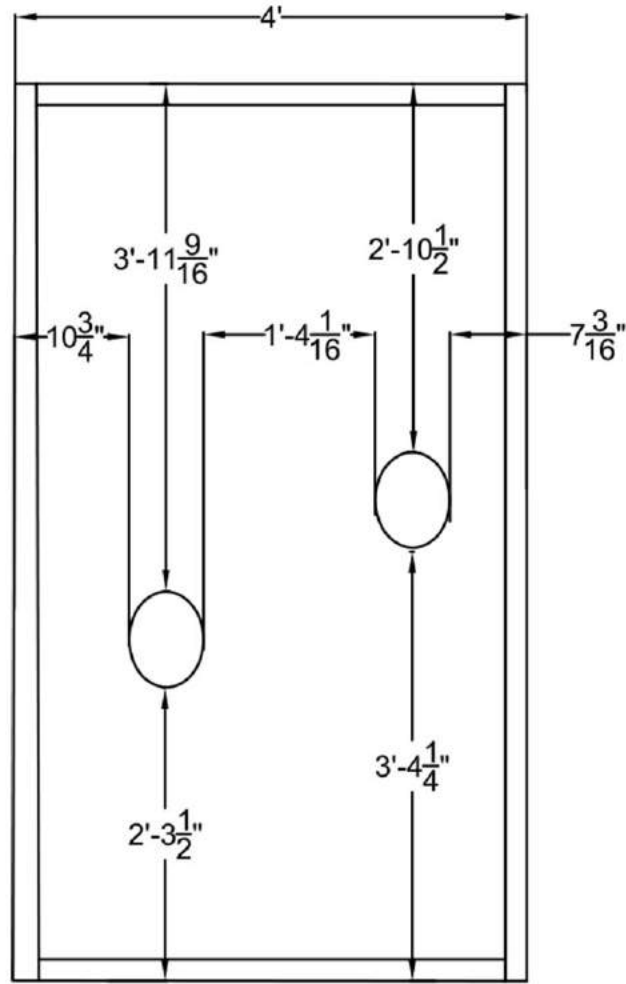

1 FRONT ELEVATION  
SCALE: 1/2"=1'

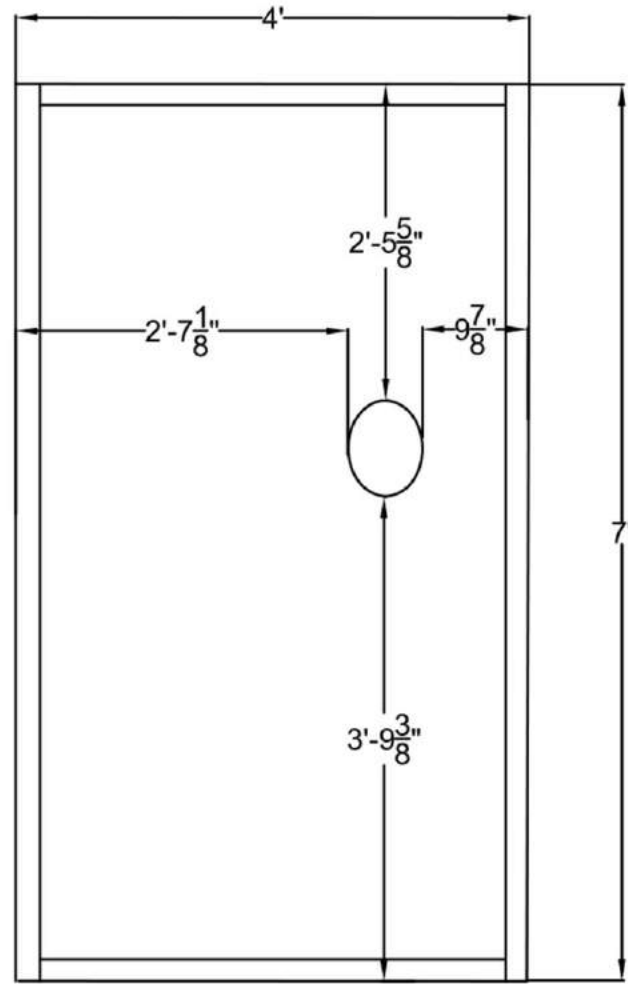

2 SIDE ELEVATION  
SCALE: 1/2"=1'

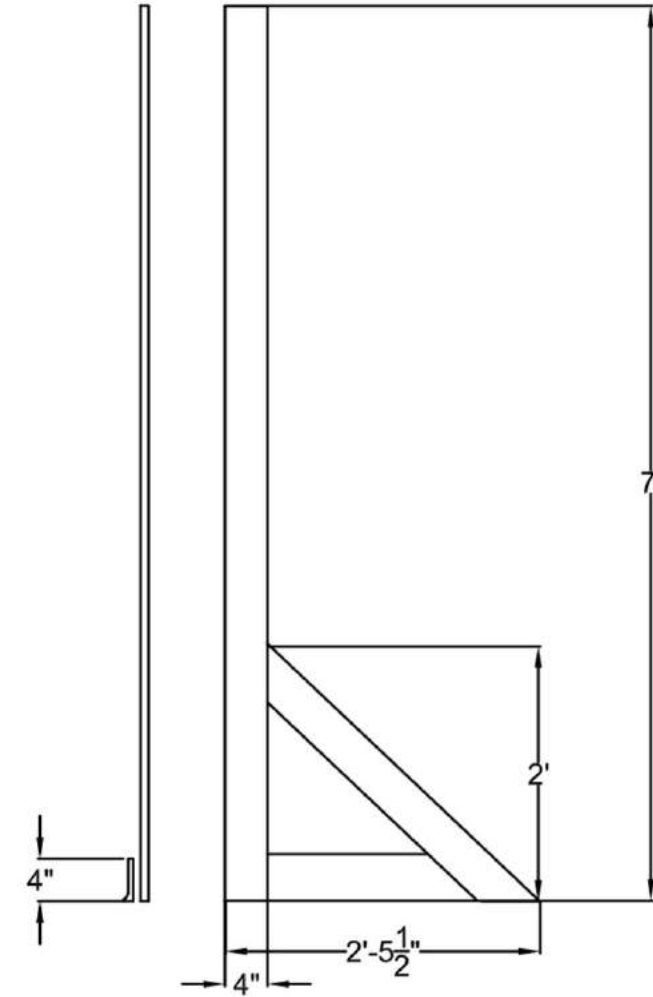

CONCEPT RENDER

**RIPLEY**  
ENTERTAINMENT, INC.  
7576 KINGSPONTE PKWY #188  
ORLANDO, FLORIDA 32819  
(407).345.8010  
  
WWW.RIPLEYS.COM

PROJECT LOCATION:  
  
NOTES:

PROJECT TITLE:  
**Ripley's**  
**Believe It or Not!**

DATE:  
10-1-18  
REVISED DATE:  
9-6-19  
SCALE:

DRAWN BY:  
C. COYLE  
APPROVED BY:

SHEET #



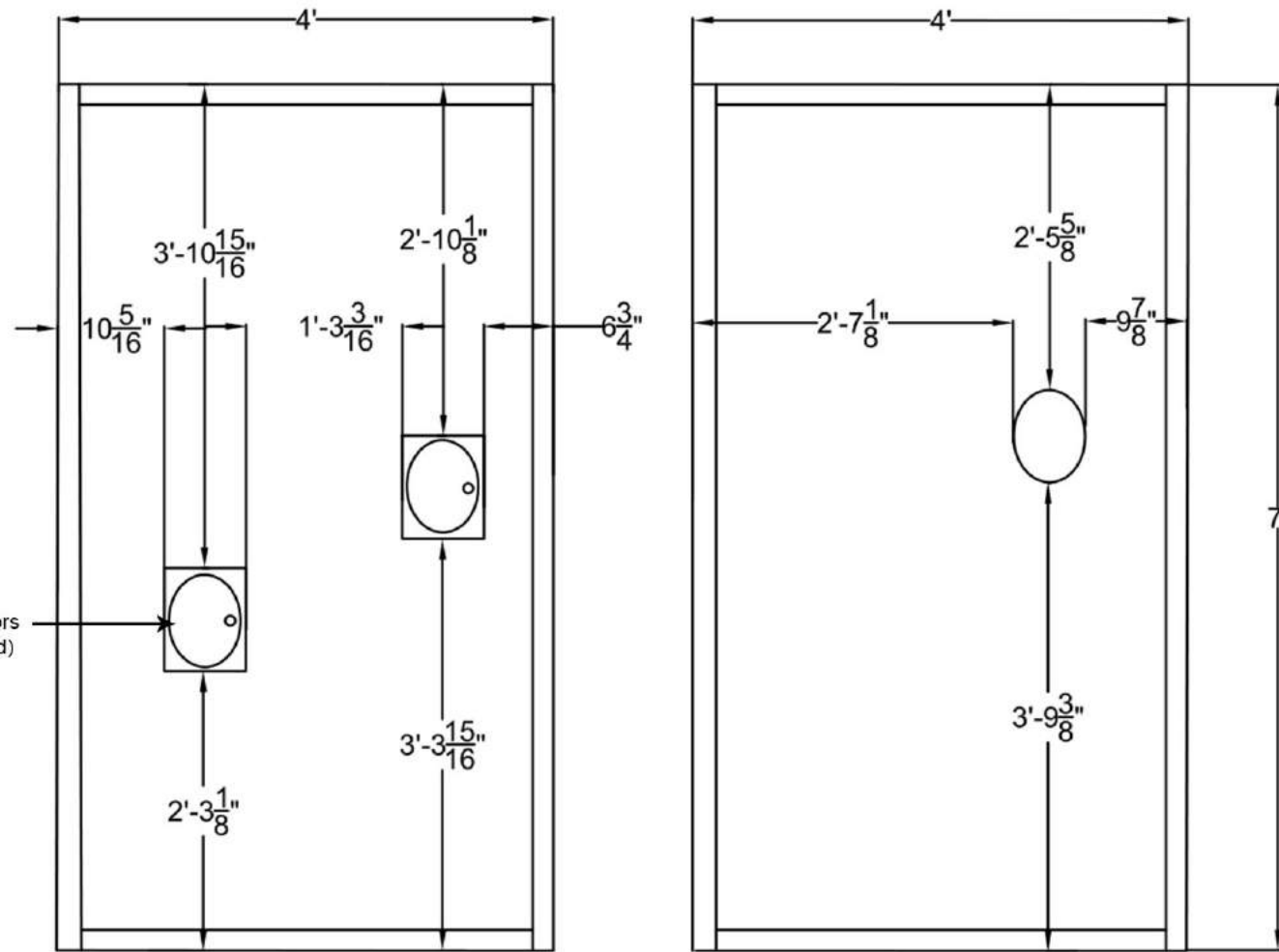

Piano hinges to support doors  
(not pictured)

**3** BACK ELEVATION  
SCALE: 1/2" = 1'

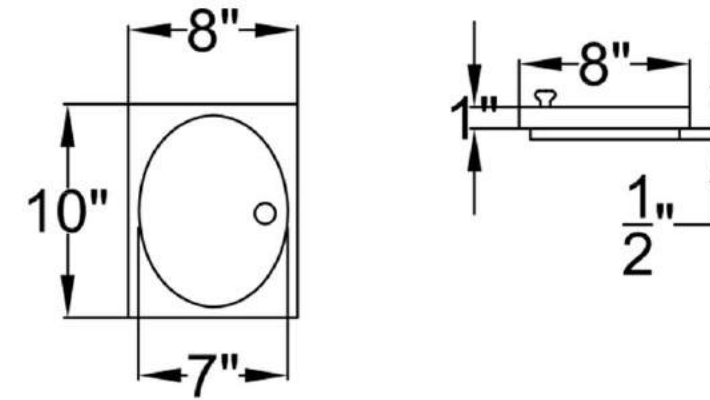

**4** DOOR DIMENSIONS -QTY:2  
SCALE: 1" = 1'

**RIPLEY**  
ENTERTAINMENT, INC.  
7576 KINGSPONTE PKWY #188  
ORLANDO, FLORIDA 32819  
(407).345.8010  
  
WWW.RIPLEYS.COM

PROJECT LOCATION:  
  
NOTES:

PROJECT TITLE:  
*Ripley's*  
**Believe It or Not!**

DATE:  
10-1-18  
REVISED DATE:  
9-6-19  
SCALE:

DRAWN BY:  
C. COYLE  
APPROVED BY:

SHEET #



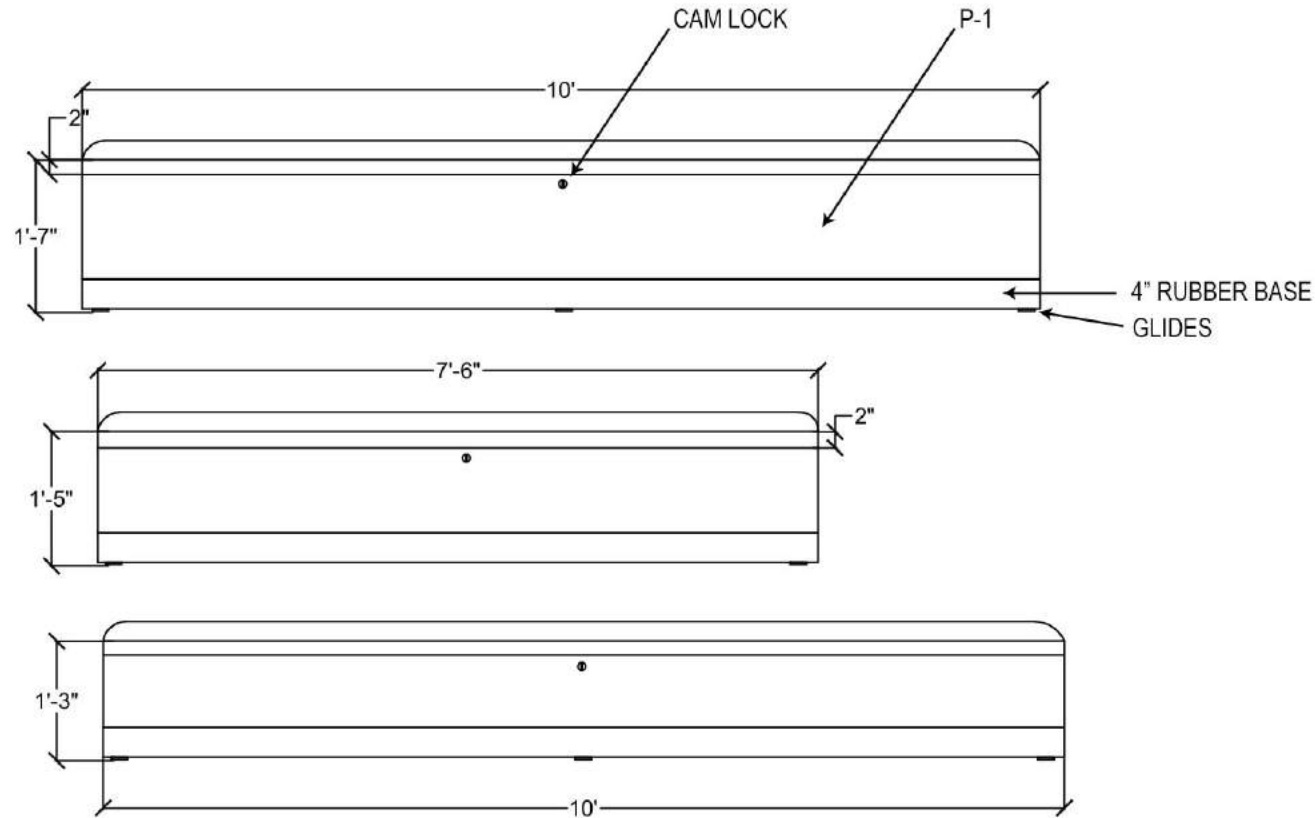

1 FRONT ELEVATION  
SCALE: 1/2"=1'

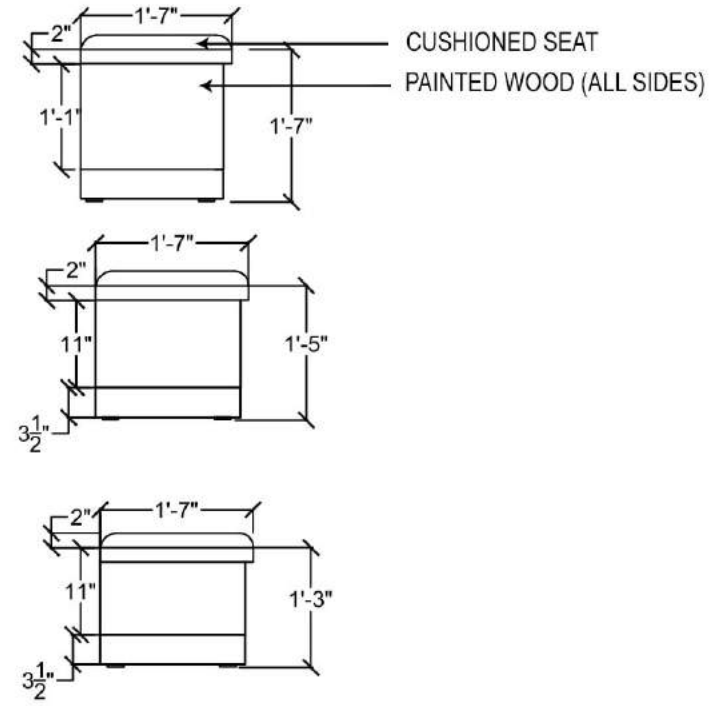

2 SIDE ELEVATION  
SCALE: 1/2"=1'

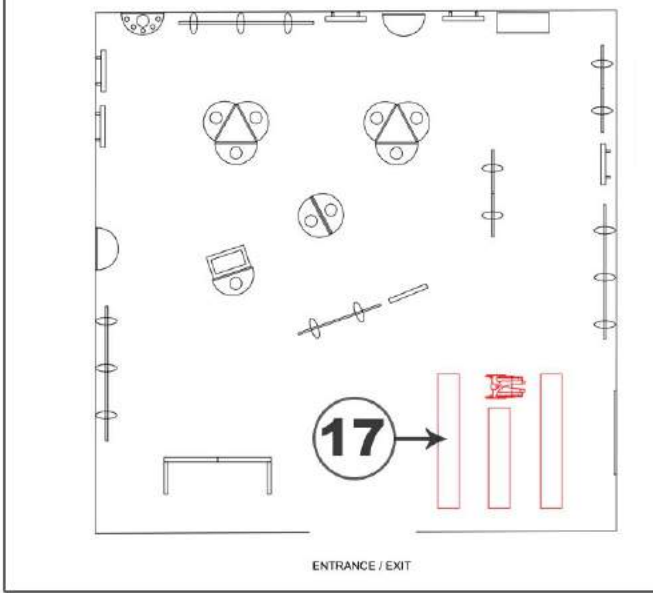

**KEY ELEVATION**

COLOR OPTION 1

	P-1 [PAINT 1] SW 6776 BLUE NILE
--	---------------------------------------

COLOR OPTION 2

	P-1 [PAINT 1] SW 6496 OCEANSIDE
--	---------------------------------------

**NOTES:**

Fabric color for cushioned seat to match paint color.  
Use black rubber for kickplate

**17** BENCHES

**RIPLEY**  
ENTERTAINMENT, INC.  
7576 KINGSPONTE PKWY #188  
ORLANDO, FLORIDA 32819  
(407).345.8010  
  
WWW.RIPLEYS.COM

PROJECT LOCATION:  
  
NOTES:

PROJECT TITLE:  
**Ripley's Believe It or Not!**

DATE:  
10-1-18  
REVISED DATE:  
9-6-19  
SCALE:

DRAWN BY:  
C. COYLE  
APPROVED BY:

SHEET #





Wigan cut-out graphic

### NOTES

Utilize existing stands (Qty:2) - See reference image

3/4" Thick plywood for cut-out

Use black laminate for the back and sides of cut out

Have 20"x 20" black laminate base on back of cutout for stands.

SAV to be installed onsite

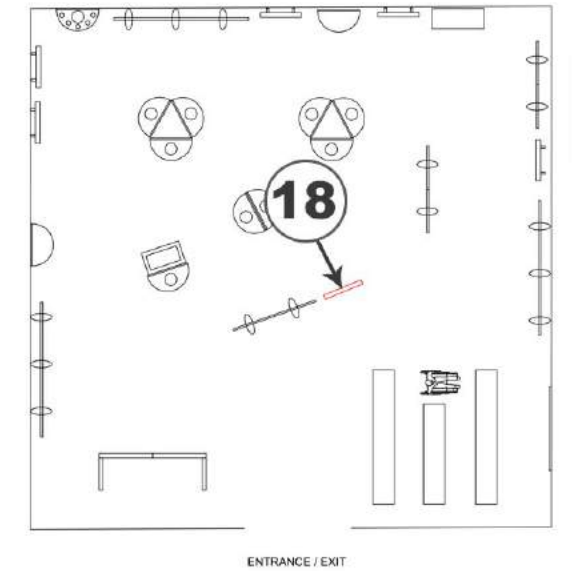

### KEY ELEVATION



Stand Reference Image

**18** Wigan Cut-Out Figure

**RIPLEY**  
ENTERTAINMENT, INC.  
7576 KINGSPONTE PKWY #188  
ORLANDO, FLORIDA 32819  
(407).345.8010  
  
WWW.RIPLEYS.COM

PROJECT LOCATION:  
  
NOTES:

PROJECT TITLE:  
  
**Ripley's**  
**Believe It or Not!**

DATE:  
10-1-18  
REVISED DATE:  
9-6-19  
SCALE:

DRAWN BY:  
C. COYLE  
APPROVED BY:

SHEET #